

EP2000 Series Low Frequency Pure Sine Wave Inverter

Feature:

- Wide input voltage range
- Built in AVR.
- LED/LCD option.
- Super transformer.
- Max charge current 25A.
- Generator compatible.
- Overload and short circuit protection
- Cold start function
- Pure sine wave output

Front Panel



Introduction:

This manual contains information regarding the installation, operation and use of the equipment. It is advised that this User's Manual should be consulted before installation of the equipment, which operation shall only be carried out by qualified personnel. Thereafter, it shall be kept and referred to whenever it is necessary to carry out work on the equipment.

LCD Display Information

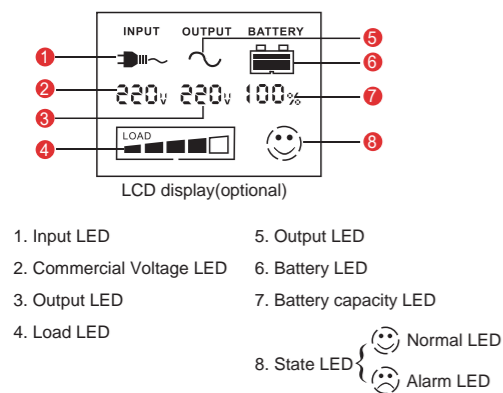
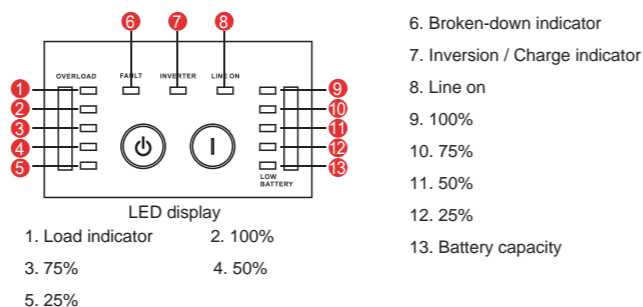
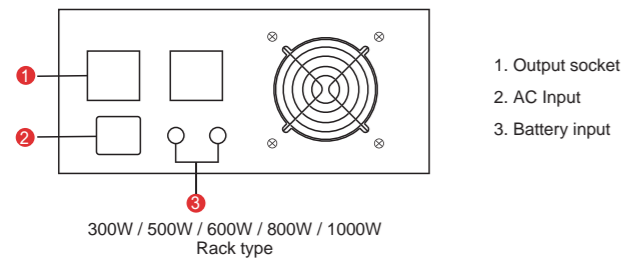
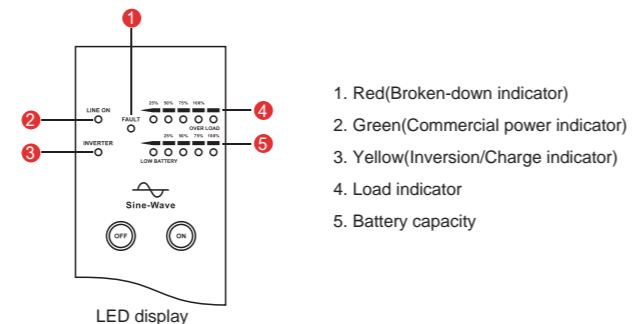
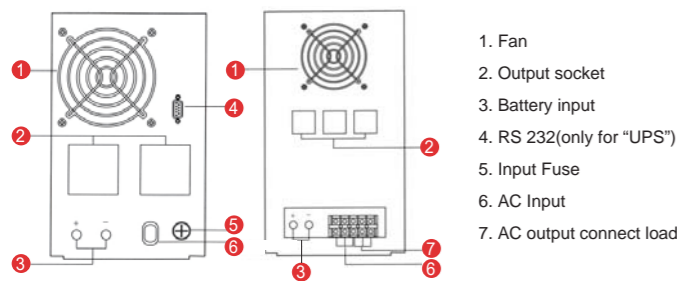

Back Panel



Specification

MODEL(EP20-)	300	500	600	800	1000	600T	1000T	1500T	2000T	3000T	4000T	6000T	8000T	10000T		
Default Battery System Voltage		12VDC	12VDC	12VDC	12VDC/24VDC	12VDC	12VDC/24VDC	24VDC	48VDC	96VDC						
INVERTER OUTPUT	Rated Power	300W	500W	600W	800W	1000W	600W	1000W	1500W	2000W	3000W	4000W	6000W	8000W	10000W	
	Waveform	Pure sine wave														
	Nominal Output Voltage RMS	100V/110V/120VAC 220V/230V/240VAC(+/-10% RMS)										220V/230V/240VAC(+/-10% RMS)				
	Output Frequency	50Hz/60Hz +/-0.3 Hz														
	Inverter Efficiency(Peak)	>80%														
	Line Mode Efficiency	>95%														
	Power Factor	1.0														
Typical Transfer Time	Typical 2-6ms ,10ms max															
AC INPUT	Nominal Voltage	100V/110V/120VAC 220V/230V/240VAC										220V/230V/240VAC				
	Voltage Range	96-132VAC/145-275VAC(For Personal Computers)										145-275VAC(For Personal Computers)				
	Frequency Range	50Hz/60Hz (Auto sensing 44-68Hz)														
BATTERY	Nominal Input Voltage	12VDC	12VDC/24VDC		12VDC	12VDC/24VDC	24VDC	48VDC	96VDC							
	Minimum Start Voltage	10.5VDC /21.0VDC/42VDC/84VDC														
	Low Battery Alarm	10.5±0.3V /21VDC±0.6V/42VDC±1.2V/84VDC±2.4V														
	Low Battery Cutoff	10.0±0.3V/20VDC±0.6V/40VDC±1.2V/80VDC±2.4V														
	High Voltage Alarm	15.5±0.3V/31VDC±0.6V/62VDC±1.2V/124VDC±2.4V														
High Battery Voltage Recover	15.0±0.3V/30VDC±0.6V/60VDC±1.2V/120VDC±2.4V															
CHARGER	Charger Voltage	14V±0.2V/28V±0.4V/56V±0.8V/112V±1.2V														
	Overcharge Protection S.D.	15.5VDC/31VDC/62VDC/124VDC														
	Maximum Charge Current	15A-25A														
BYPASS & PROTECTION	Nominal Input Frequency	50Hz or 60Hz														
	Overload Protection(SMPS Load)	IPS automatically shutdown if overload exceeds 120% of normal value for 30 seconds IPS automatically resume work if overload comes back to rated load														
	Output Short Circuit Protection	FUSE							Circuit breaker							
	Bypass Fuse Rating	10A							15A	30A	50A					
	Max Bypass Current	10A							15A	30A	50A					
MECHANICAL SPECIFICATIONS	Dimensions(W*H*D)(mm)	265*120*295					140*182*380			190*350*450				260*750*570		
	Net Weight(kg)	7.0	9.5	10.5	12	12.5	11	12	24.2	27.4	29.5	33	41	47	53	
	Shipping Dimensions(W*H*D)(mm)	316*185*377					215*285*465			325*473*595				480*1030*720		
Shipping Weight(kg)	7.5	10	11	12.5	13	12	13.2	26.9	30.1	33.2	35.7	55	61	67		
OTHER	Operation Temperature Range	0°C to 40°C														
	Audible Noise	60dB MAX														
	Display	LED or LCD Optional														
Loading(20GP/40GP/40HQ)	1200pcs / 2400pcs / 2800pcs					950pcs/2100pcs/2300pcs			270pcs / 500pcs / 600pcs				60pcs / 110pcs / 140pcs			

* Product specifications are subject to change without further notice.

Approximate Back-up Time Table

Power Rate(w)	backup time(H) @1*100Ah	backup time(H) @2*100Ah	backup time(H) @4*100Ah	backup time(H) @4*200Ah	backup time(H) @8*200Ah
300	3.5	7	14	28	
500	2.1	4.2	8.4	16.8	
600	1.75	3.5	7	14	
800	1.3	2.6	5.2	10.4	
1000	1	2.1	4.2	8.4	
2000		0.4806	1.602	3.50304	7.6896
3000		0.2848	0.8544	2.136	4.8146
4000			0.4806	1.602	3.50304
6000			0.2848	0.8544	2.136
8000					2.4
10000					1.7